

THESE DRAWINGS AND SPECIFICATIONS ARE THE PROPERTY OF JBL INCORPORATED. THEY ARE ISSUED IN STRICT CONFIDENCE AND SHALL NOT BE REPRODUCED OR USED AS THE BASIS FOR MANUFACTURE OR APPARATUS WITHOUT WRITTEN PERMISSION.

ALL MATERIAL SPECIFIED ON THIS DRAWING SHALL COMPLY WITH EUROPEAN DIRECTIVE 2002/95/EC. **RoHS**

REVISIONS					
CHG	LETR	DESCRIPTION	DRFT	D/C	DATE
38815	A	RELEASE TO MARKETING	FL		

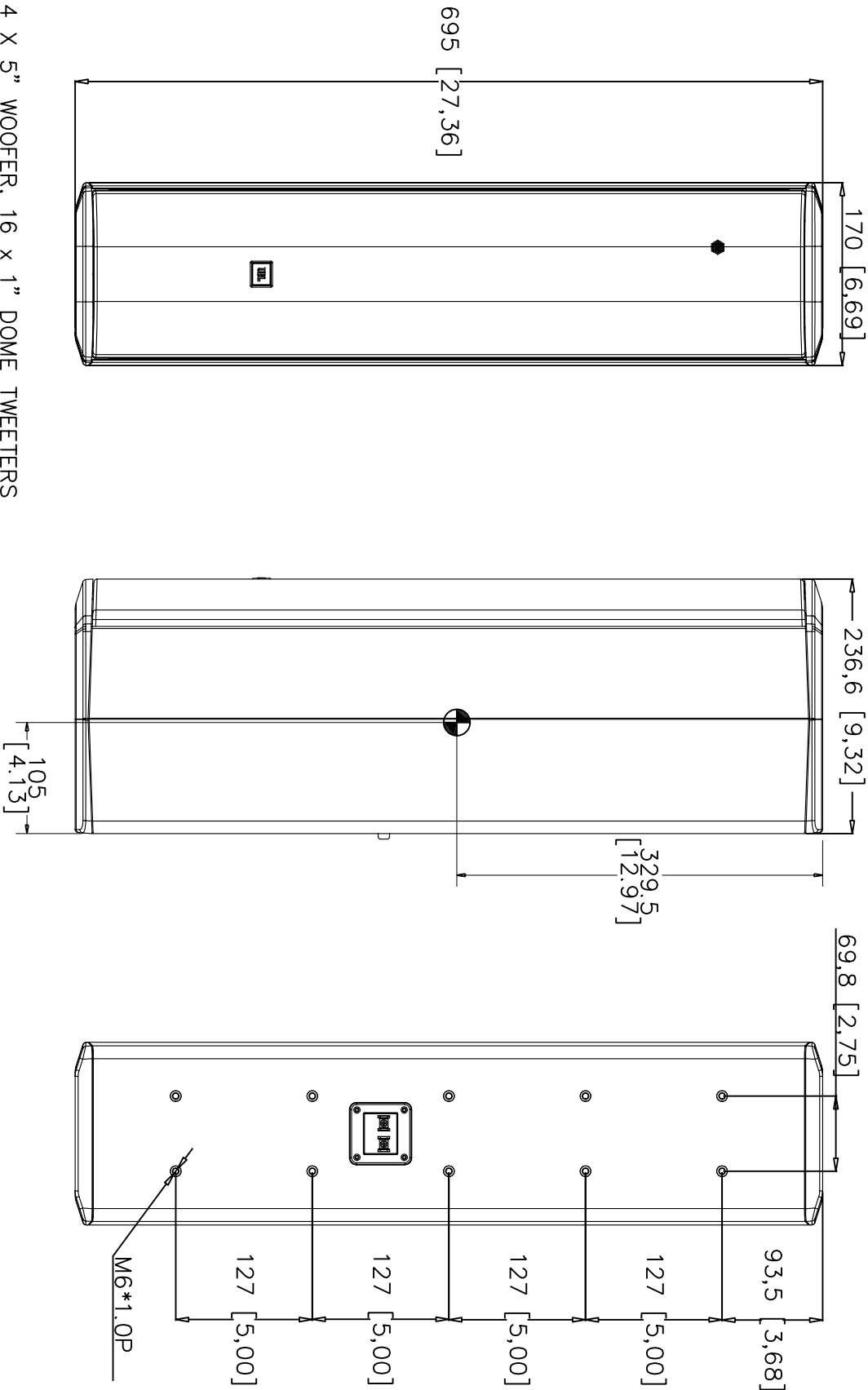
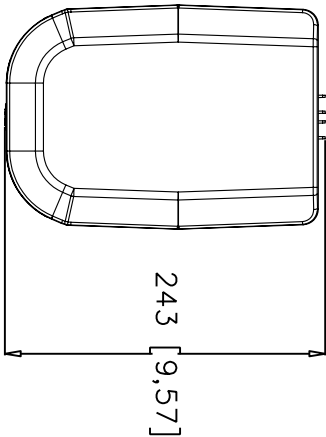

1. COMPONENTS: 4 X 5" WOOFER, 16 X 1" DOME TWEETERS
2. INPUT CONNECTORS: BARRIER STRIP3
3. GRILL: PERFORATED UV RESISTANT PAINTED ALUMINUM
4. MATERIALS: CABINET GLASSFILLED ABS
5. FINISH: UV RESISTANT PAINT
6. RIGGING SYSTEM: 10 X M6 INSERTS ON REAR PANEL AND INCLUDED CBT70J COUPLER PLATE.
7. WEIGHT: 8.2kg (18lbs)
8. CENTER OF GRAVITY (CG)

NOTES: (UNLESS OTHERWISE SPECIFIED)

TOLERANCES (UNLESS OTHERWISE SPECIFIED)		<div>JBL</div> <div>JBL PROFESSIONAL A Harman International Company Northridge, California 91329 U.S.A.</div>	
XXX ± .063 INCH		TITLE  CUSTOMER DRAWING: CBT 70JE	
XX ± .125 INCH			
ANGULAR TOLERANCE OF 0°-30°		SIZE A	
FRACTIONAL DIMENSIONS ± 1/32			
* DIMENSIONS ARE INCHES		DRAWING NO. 444439	
* ALL DIMENSIONS ARE FINISHED DIMENSIONS			
* DO NOT SCALE DRAWING		REV A	
SCALE		NTS	
SHEET 1		OF 1	